

UNIHOIST LTD

Bath Hoists



Unihoist Ltd have been manufacturing mobile lifting hoists for 13 years, however some of our personnel have been involved in manufacturing rehabilitation equipment for 34 years. The Company is based in Oxford. Our products are well made with quality, service and price in mind and manufactured to C.E. standard. They are finished in a nylon coating for durability and warmth, this also enables easy cleaning.

University Bath Hoist



The University Bath Hoist is a fixed floor hoist finished in a white nylon coating. The hoist moves through 360° so that the client can be located to the seat in many positions. It has a locking position every 90° to ensure a safe and secure transfer.

The moulded seat is raised and lowered into the bath by an easy to use winding handle. The installation can be made at the side or end of the bath.

It is available in both electric and hydraulic versions and an electric conversion kit is available for the manual version.

Key Features (manual version) :

- Weight Capacity 130 kg
- Wooden or concrete floor fixings
- Side or end fit configuration
- Lap Belt

Key Features (electric version) :

- Weight Capacity 130 kg
- Wooden or concrete floor fixings
- Side or end fit configuration
- Lap Belt
- Detachable battery pack
- LCD battery level indicator
- Emergency lift & lower functions



Bath Hoist Transporter



The Bath Hoist Transporter gives easy access to the bath. The hoist can also be used as a toileting aid.

Standard Features:

- Adjustable footrest
- Lap belt
- Safety arms
- Commode seat

Options:

- MD padded seat
- Bed pan and cradle

Bath Hoist Commode



The Bath Hoist Commode is a standard bath hoist that comes with commode seat . The hoist is also available in both electric and manual version and can be fixed either to the side or end of the bath.

Options:

- Fitted wrap around arms (as shown on the picture)

Fitting Illustration

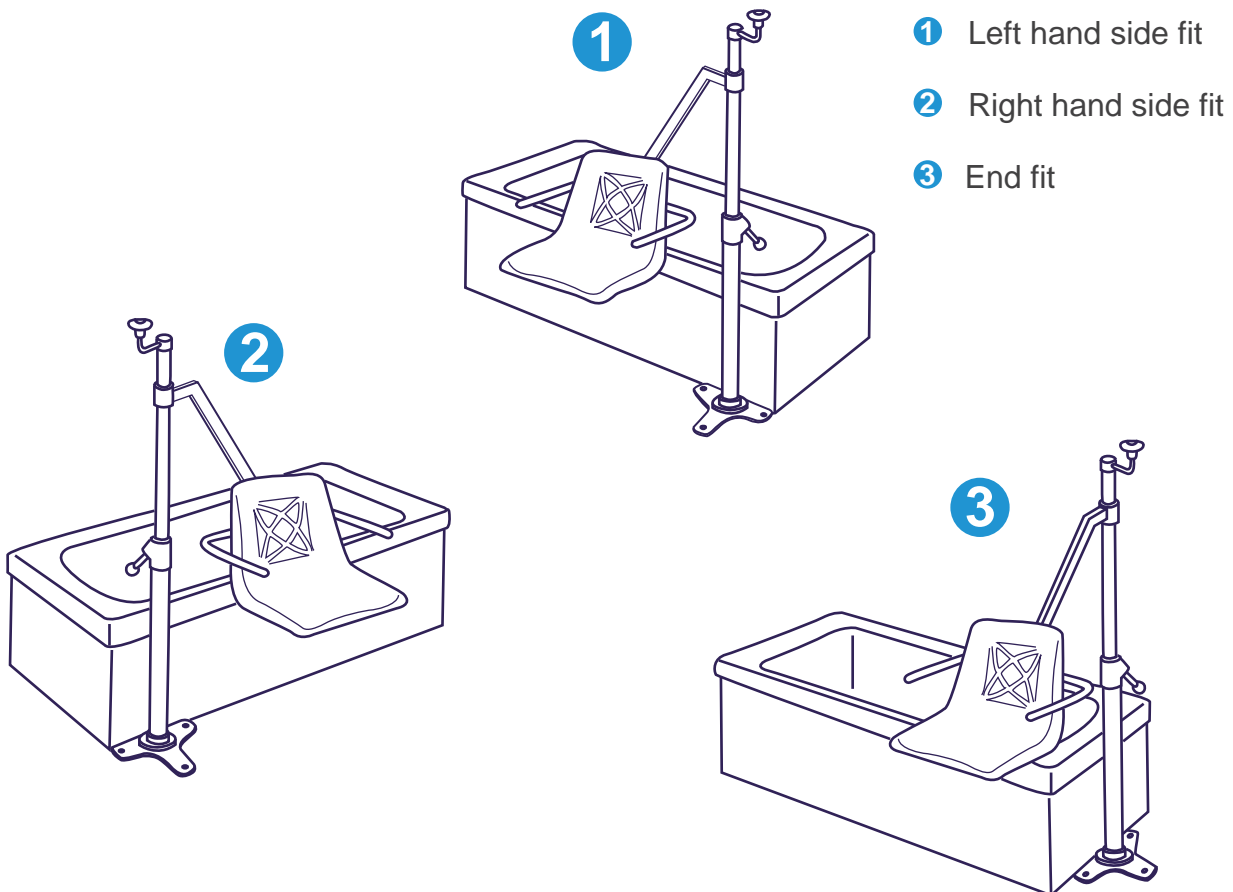

TECHNICAL SPECIFICATIONS

| Model | Bath Hoist | | Commode | | Transporter | |
|---|------------|-----------|----------|-----------|-------------|-----------|
| | Electric | Hydraulic | Electric | Hydraulic | Electric | Hydraulic |
| Safe working load | 130 kg | 130 kg | 130 kg | 130 kg | 130 kg | 130 kg |
| Highest position from base of seat | 715 | 740 | 715 | 740 | 715 | 740 |
| Lowest position from base of seat | 140 | 140 | 140 | 140 | 140 | 140 |
| Seat travel | 485 | 485 | 485 | 485 | 485 | 485 |
| Width of seat | 450 | 450 | 360 | 360 | 360 | 360 |
| Width between arms | 395 | 395 | 395 | 395 | 430 | 430 |
| Depth of seat (front to back) | 485 | 485 | 566 | 566 | 553 | 553 |
| Centres between mast and seat | 1005 | 1005 | 1094 | 1094 | 1295 | 1295 |
| Max. seat turning circle (side fit) | 510 | 510 | 521 | 521 | 770 | 770 |
| Max. seat turning circle | 485 | 485 | 570 | 570 | 655 | 655 |
| Minimum recommended clearance from mast to allow for leg room | 753 | 753 | 853 | 853 | 970 | 970 |
| Weights | | | | | | |
| | 33.0 kg | 28.2 kg | 33.0 kg | 28.2 kg | 44.0 kg | 39.9 kg |
| Power pack | 4.0 kg | - | 4.0 kg | - | 4.0 kg | - |

Electrical Specifications

Batteries 2 x 12 volt Rechargeable sealed lead acid type
 Battery capacity : 3.2 Ampere Hours
 Charger Rated Input: 230Vac 50/60Hz
 Charger Rated Outp 27.4/29.0 VDC@0.8A
 Fuse - Hoist 10A Fast Blow _" x1.1/4"

Electric Shock Protection

Charger Class II
 Double Insulted Hoist - Internal Power Source

Degree of Shock Protection

Charger - Type B
 Hoist - Type B
 Mode of operation - 15% Intermittent Duty



All our products are guaranteed for one year from date of purchase against all faults arising from faulty equipment or workmanship. Faulty equipment will be repaired or replaced free of charge after receipt and examination at our works.



Unihoist Ltd
 Unit C, Anvil Court, Stanton Harcourt Road
 Eynsham, Oxford, OX29 4UD
 Tel: 01865 881881
 Fax: 01865 883434

Email: unihoistltd@btconnect.com
 sales@unihoist.co.uk
 www.unihoist.co.uk

